

Style  
"A"

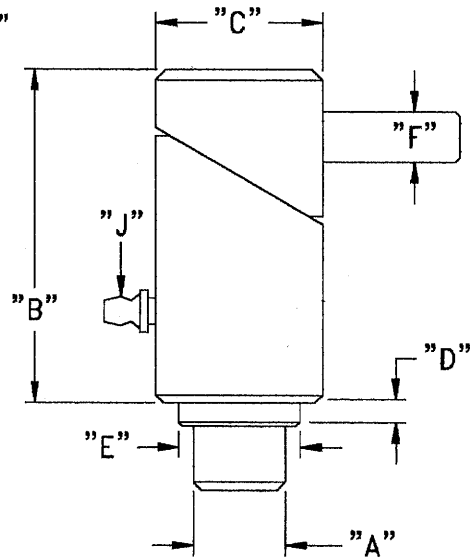

Style  
"B"

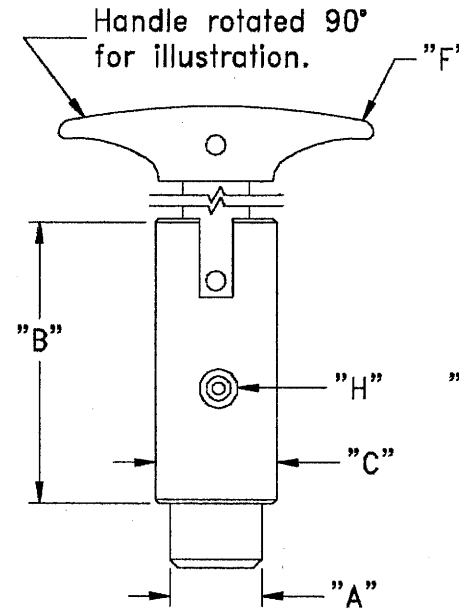

Style  
"C"

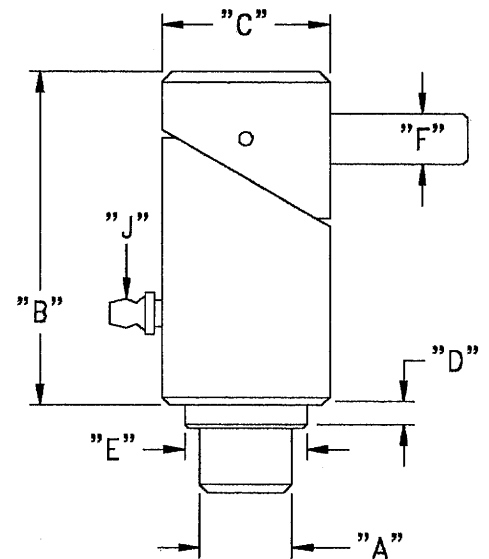

Style  
"D"

Style	Description	Part Number	"A"	"B"	"C"	"D"	"E"	"F" Handle	"G" Cap	"H" or "J" Locate	Finish	Used on
A	5/8" Cam Lock	MP-9250A	5/8"	2 5/16"	1 3/16"	3/16"	0.86"	Round./Thread	YES	"H"	Z.P.	Various
A	3/4" Cam Lock	MP-9150A	3/4"	2 3/8"	1 3/16"	3/16"	0.96"	Round./Thread	YES	"H"	Z.P.	Various
A	1" Cam Lock	MP-9450A	1"	2 3/4"	1 3/8"	3/16"	1.24"	Round./Thread	YES	"H"	Z.P.	Various
A	1 3/8" Cam Lock	MP-9550A	1 3/8"	2 15/16"	1 3/4"	3/16"	1.74"	Round./Thread	YES	"H"	Z.P.	Various
D	1" Cam Lock	TS-6423A	1"	3 3/16"	1 1/2"	No	No	Round./Pinned	N/A	"J"	None	D.P.M.
B	11/16" Cam Lock	MP-9300A	11/16"	2 13/16"	1 1/8"	No	No	Round./Thread	N/A	"J"	None	JERR-DAN
A	0.725" Cam Lock	MP-9310A	0.725"	2 11/16"	1 1/4"	3/16"	0.99"	Hex./Thread	N/A	"H"	None	CHEVRON
A	0.725" Cam Lock	MP-9320A	0.725"	2 13/16"	1 1/4"	No	No	Hex./Thread	N/A	"H"	Z.P.	MILLER.
C	5/8" T-Handle Lock Housing	TS-6025A	5/8"	2 3/4"	1"	No	No	Alum.T/Pinned	N/A	"H"	None	D.P.M.