



DIVERSIFIED PRODUCTS MANUFACTURING

8330 ATLANTIC BLVD. JACKSONVILLE, FL. 32211
 1-800-874-4172, (904) 724-0310, FAX (904) 724-4494

CABLE TENSIONER MODEL: CT-100 & CT-100-L

INSTALLATION INSTRUCTIONS

1. ALIGN THE FRONT OF THE BASE WITH THE EDGE OF MOUNTING ANGLE NEAREST THE WINCH. CENTER ON WINCH USING TENSIONING PLATE AS GUIDE.
2. MARK HOLE LOCATIONS. REMOVE BASE AND DRILL TWO 1/2" TO 9/16" HOLES. (HOLE DIMENSIONS FIG. #2)
3. MOUNT BASE TO MOUNTING ANGLE USING TWO 1/2" X 1" HEX BOLTS, TWO 1/2" FLAT WASHERS, AND TWO 1/2" LOCKNUTS.
4. ATTACH A PUSH CAP TO ONE END OF PIVOT ROD AND ASSEMBLE TENSIONING PLATE TO BASE WITH PIVOT ROD AS SHOWN IN FIG. #1.
5. ATTACH COMPRESSION SPRING TO UNDERSIDE OF MOUNTING ANGLE USING 3/8" X 8" CARRIAGE BOLTS, 3/8" FLATWASHERS, AND 3/8" HEX NUTS. (AS SHOWN IN FIG. #1.)
6. TIGHTEN 3/8" HEX NUT UNTIL DESIRED TENSION IS ATTAINED.

USED ON

CT-100 1 1/4" WINCH	HOLMES 440-182 CHALLENGER 4700
CT-100-L 1 1/2" WINCH	CHALLENGER 4800

ITEM #	PT #	DESCRIPTION	QTY.
1.	X-095	3/8" X 8" CARRIAGE BOLT	2
2.	X-328	1/2" FLATWASHER	4
3.	CT-105	TENSIONING PLATE 11"	1
	CT-105-L	TENSIONING PLATE 11-1/2"	
4.	X-032	1/2" X 1-1/2" HEX BOLT	2
5.	X-224	1/2" PUSH CAP	2
6.	CT-101	BASE	2
7.	X-227	1/2" NYLOCK NUT	1
8.	CT-102	1/2" X 9 PIVOT ROD	1
9.	CT-149	COMPRESSION SPRING	2
10.	X-315	3/8" FLAT WASHER	2
11.	X-220	3/8" HEX NUT	2

TOP VIEW OF BASE

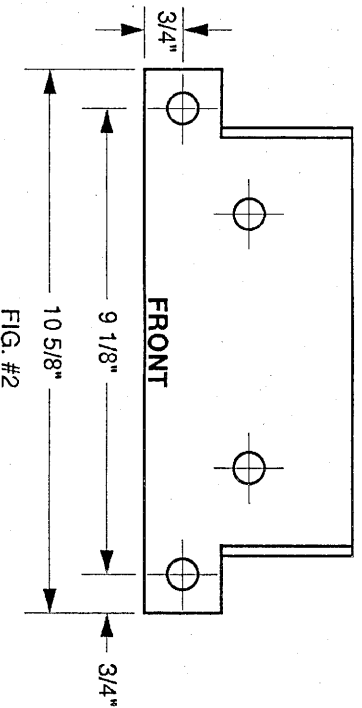

FIG. #2

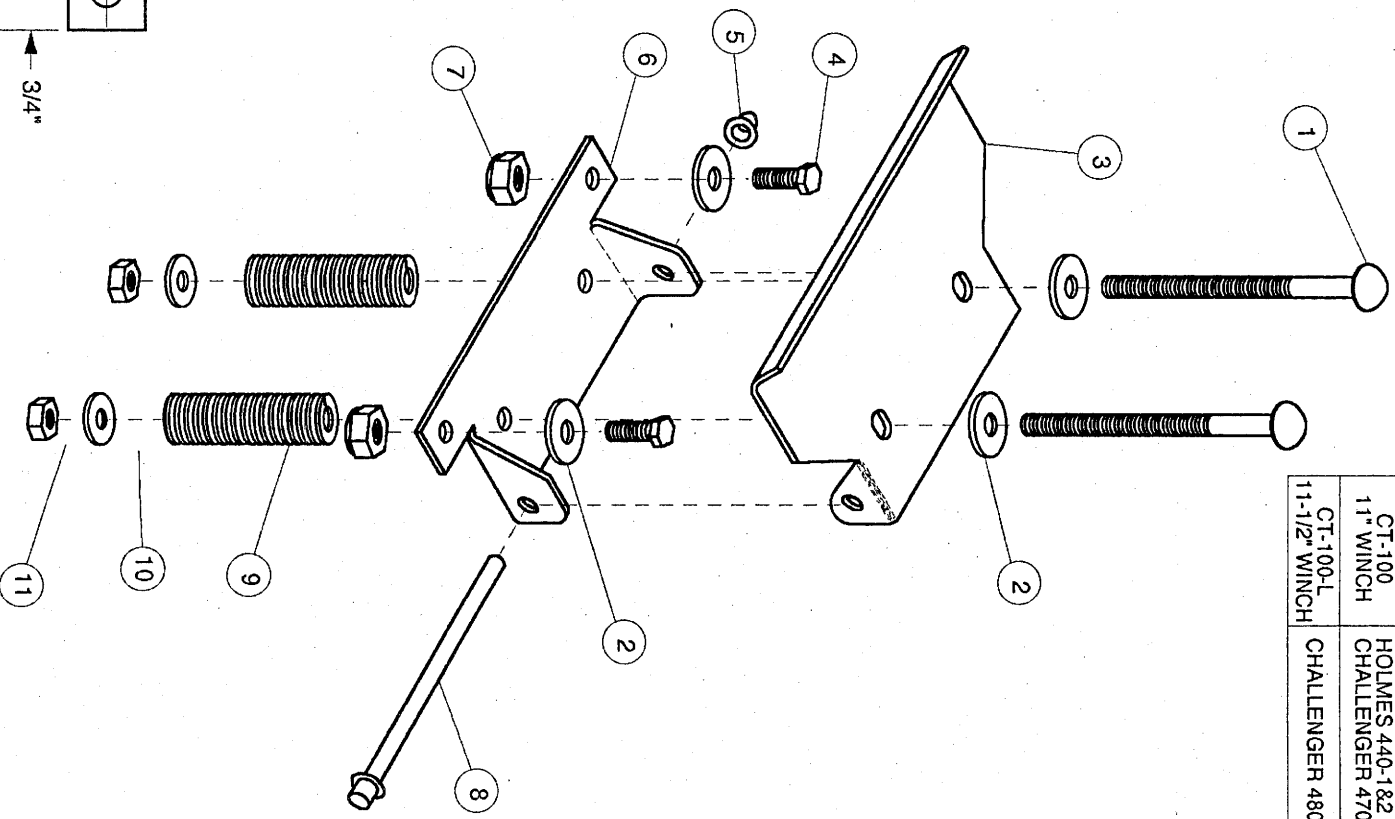

FIG. #1