

# TS-30/34 Series Tow Slings

Item #	Part #	Description
1)	TS-6005A	34" (XL) Sling Arm Assembly Complete
	TS-6322-1A	30" (short) Sling Arm Assembly Complete
2)	TS-6301	2-Way Hinge (5/8" pin, 1/2" bolt, 1 7/8" Center-to-center)
2a)	TS-6301C	2-Way Hinge, w/offset (5/8" pin, 1/2" bolt, 3 1/4" Center-to-center)
2b)	TS-6285	2-Way Hinge, (5/8" pin, 1/2" bolt, 15/16" Center-to-center)
2c)	TS-6296	2-Way Hinge, (5/8" pin, 1/2" bolt, 1 1/2" Center-to-center) <i>TS-30-5 only</i>
	TS-6071	2-Way Hinge, (3/4" pin, 1/2" bolt, 1 1/2" Center-to-center, 3 3/4" wide) <i>TS-34-3 only</i>
3)	X-380	5/8"x5 1/2" Clevis Pin (zp) <i>must match pin hole size on 2-way hinge</i>
	X-380C	5/8"x5 1/2" Clevis Pin, w/hole at head end (zp) <i>must match pin hole size on 2-way hinge</i>
	X-382	3/4"x5 1/2" Clevis Pin (zp) <i>must match pin hole size on 2-way hinge</i>
4)	X-358	Safety Pin (zp)
5)	X-227	Nylock Nut, 1/2" (zp)
6)	X-035	Hex Bolt, 1/2"x2 1/2" G5 (zp)
7)	X-407	Roll Pin, 5/32"x 7/8" (zp)
	X-409	Roll Pin, 5/32"x1 1/8" (zp)
8)	TS-6028	5/8" Plunger
9)	TS-6027	Spring
10)	TS-6026	Aluminum Handle
11)	TS-6288	Lower Bar Weldment
12)	TS-6320	Retainer Washer
13)	X-756	1" NF Slotted Jam Nut (zp)
14)	TS-6494	Sling Belting Clamp
15)	X-310	Flat Washer, 5/16" (zp)
16)	X-215	Nylock nut, 5/16" (zp)
17)	X-014	Hex Bolt, 5/16"x1 1/2" Gr. 8 (zp)
18)	TS-6013HP	Sling Belt
19)	X-015	5/16"x3 1/2" Carriage Bolt (zp)
20)	TS-6311H	Pivot Assembly (w/arm hardware)
21)	X-556	Anchor Shackles, 5/8" (galvanized)
22)	TS-6412	Front Sling Belting Plate
23)	TS-6410	Back Sling Belting Plate
24)	X-352	Cotter Pin, 1/8"x1 3/4"

Also Available: TS-6025A T-Handle Lock Assembly Complete

Arm Dimension "A"	TS-6005A	TS-6322-1A
Short-Locked Position	34.25"	30"
Mid-Locked Position	47.25"	44.25"
Full Extension (unlocked)	58.5"	49.25"

## Diversified Products Mfg.

8330 Atlantic Blvd, Jacksonville FL 32211  
 800-874-4172, 904-724-0310, Fax 904-724-4494

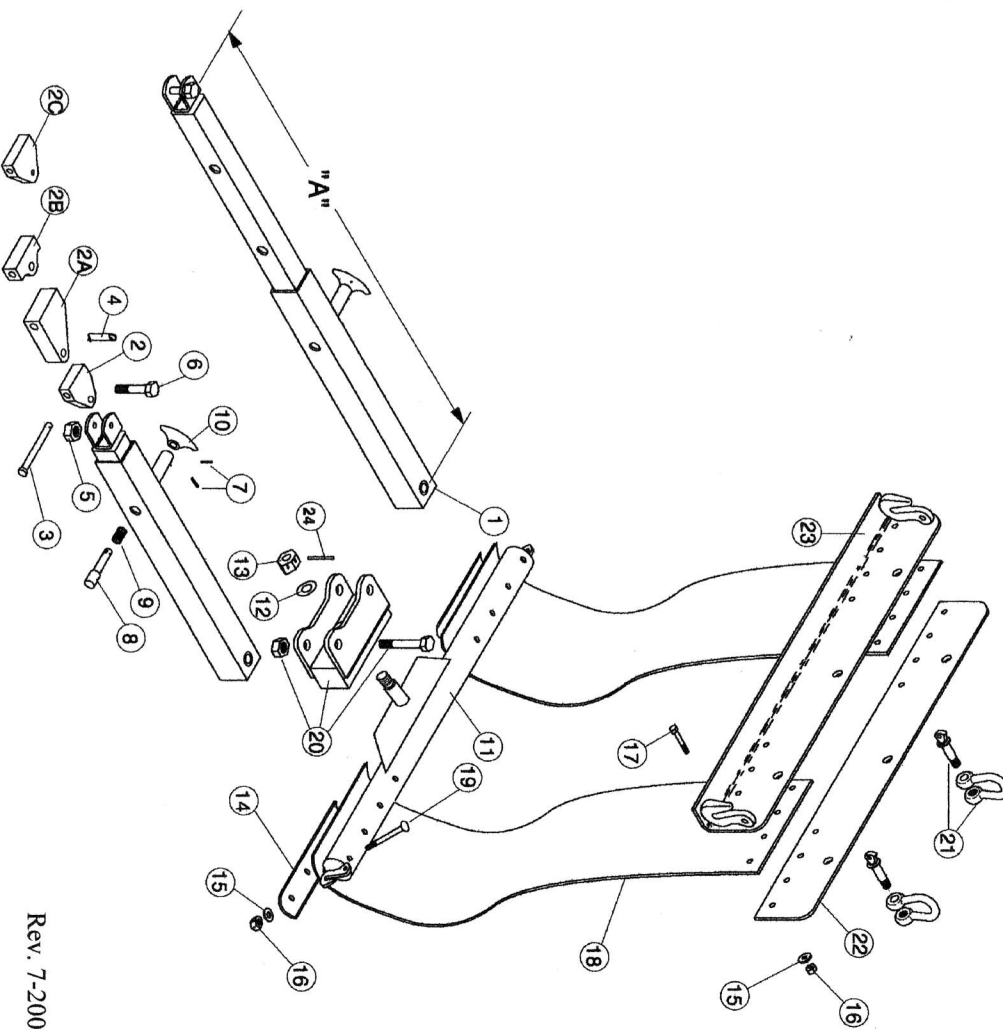

**Pushbumper.com**

Commercial Truck and Towing Accessories